

SHELL SIZE	KEY & KEYWAY IDENTIFICATION LETTER	A°	B°	C°	D°
8	N	105	140	215	265
	6	102	132	248	320
	7	80	118	230	312
	8	35	140	205	275
	9	64	155	234	304
	Y	-	-	-	-
10	N	105	140	215	265
	6	102	132	248	320
	7	80	118	230	312
	8	35	140	205	275
	9	64	155	234	304
	Y	25	115	220	270
12 thru 28 <1>	N	105	140	215	265
	6	18	149	192	259
	7	92	152	222	342
	8	84	152	204	334
	9	24	135	199	240
	Y	98	152	268	338

### POLARIZING POSITIONS

(IDENTIFICATION LETTERS ARE AS DEPICTED ON ORDERING INFORMATION PAGE)

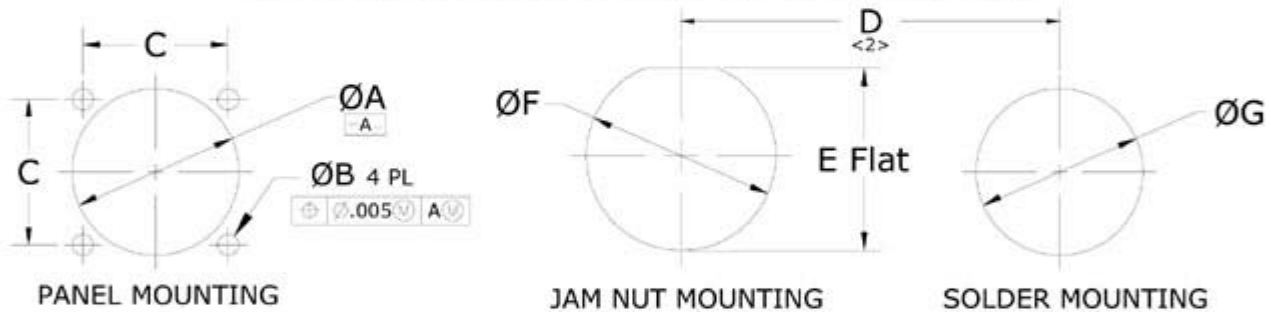

SHELL SIZE	ØA MIN	ØB	C BASIC	D MIN <2>	E Flat ±.005 [±0.13]	ØF ±.005 [±0.13]	ØG MIN
8	.623 [15.80]	.130/.122 [3.30/3.10]	.594 [15.09]	1.249 [31.70]	.605 [15.37]	.635 [16.13]	.511 [12.96]
10	.737 [18.70]	.130/.122 [3.30/3.10]	.719 [18.26]	1.375 [34.90]	.730 [18.54]	.760 [19.30]	.572 [14.53]
12	.922 [23.40]	.130/.122 [3.30/3.10]	.812 [20.62]	1.560 [39.60]	.917 [23.29]	.947 [24.05]	.760 [19.30]
14	.981 [24.90]	.130/.122 [3.30/3.10]	.906 [23.01]	1.625 [41.25]	.980 [24.89]	1.010 [25.65]	.823 [20.88]
16	1.115 [28.30]	.130/.122 [3.30/3.10]	.969 [24.61]	1.751 [44.45]	1.105 [28.07]	1.135 [28.83]	.948 [24.05]
18	1.225 [31.10]	.130/.122 [3.30/3.10]	1.062 [26.97]	1.866 [47.35]	1.229 [31.22]	1.260 [32.00]	1.073 [27.23]
20	1.359 [34.50]	.130/.122 [3.30/3.10]	1.156 [29.63]	2.045 [51.90]	1.354 [34.39]	1.385 [35.18]	1.198 [30.40]
22	1.478 [37.50]	.130/.122 [3.30/3.10]	1.250 [31.75]	2.132 [54.10]	1.479 [37.57]	1.510 [38.35]	1.323 [33.58]
24	1.600 [40.60]	.154/.145 [3.91/3.68]	1.375 [34.92]	2.256 [57.25]	1.604 [40.74]	1.635 [41.53]	1.448 [36.75]
<1> 28	1.891 [48.00]	.154/.145 [3.91/3.68]	1.562 [39.67]	2.571 [65.25]	1.851 [47.01]	1.882 [47.82]	1.697 [43.08]

<1> SIZE 28 CONNECTOR NOT PER M83723

<2> MINIMUM DISTANCE BETWEEN ANY TWO SAME-SIZE CONNECTOR CENTERS

### PANEL CUTOUTS

DIMENSIONS ARE IN INCHES [MILLIMETERS]